

Standard Conveyor Chains

Standard conveyor chain (R roller type)

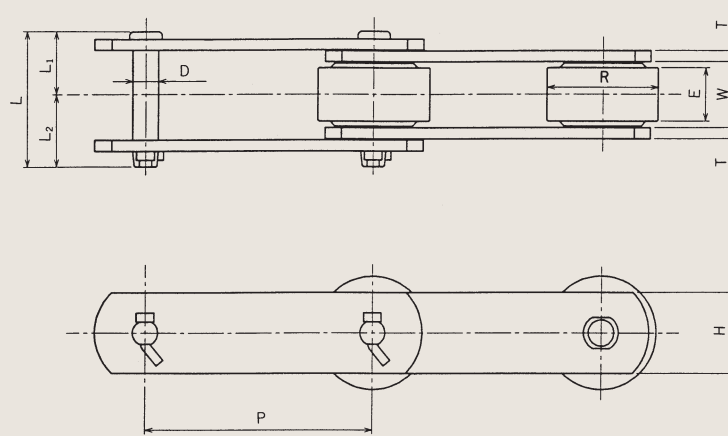

Chain No.	pitch P (mm)	Roller			Inner width W (mm)	Pin			Link plate		Average ultimate strength		Mass (kg/m)
		Outer Dia. R (mm)	face width E (mm)	Dia. D (mm)		Length			Height H (mm)	Thickness T (mm)	(kN)	(kgf)	
						L (mm)	L ₁ (mm)	L ₂ (mm)					
HRS03075-R	75	30.0	14.0	16.0	7.9	38.0	16.8	21.2	22.2	3.2	29.4	3000	2.3
HRS03100-R	100												1.9
HRS03150-R	150												1.7
HRS05100-R	100	40.0	19.0	22.0	11.0	53.4	23.9	29.5	31.8	4.7	68.6	7000	4.9
HRS05150-R	150												4.0
HR10105-R	101.6	38.1	19.0	22.6	9.5	53.0	24.2	28.8	25.4	4.7	53.9	5500	4.3
HR10108-R	101.6	44.5	23.0	27.0	11.0	65.7	30.6	35.1	28.6	6.3	78.5	8000	6.7
HR15208-R	152.4	50.8	26.0	30.2		68.0	31.4	36.6	38.1				7.8
HR10011-R	100	50.8	26.7	30.2	14.2	72.2	32.8	39.4	38.1	6.3	112.8	11500	9.8
HR15011-R	150												8.1
HR10113-R	101.6	44.5	27.0	31.6	15.8	81.3	37.3	44.0	38.1	7.9	132.4	13500	10.4
HR15215-R	152.4	57.2	32.0	37.1	15.8	87.5	40.0	47.5	44.5	7.9	186.3	19000	12.1
HR20015-R	200	65.0											11.4
HR25015-R	250	10.3											
HR15219-R	152.4	69.9	32.5	37.1	18.9	97.1	44.3	52.8	50.8	9.5	245.2	25000	17.1
HR20019-R	200	80.0	44.0	51.4		111.3	51.4	59.9					18.8
HR25019-R	250					16.5							
HR30019-R	300					15.0							
HR25026-R	250	100.0	50.0	57.2	22.1	119.6	55.3	64.3	63.5	9.5	313.8	32000	27.1
HR30026-R	300												22.3
HR45026-R	450												18.0
HR30048-R	300	125.0	56.0	66.7	25.2	143.7	67.6	76.1	76.2	12.7	475.6	48500	42.2
HR45048-R	450												30.7
HR60048-R	600												26.9
HR30054-R	300	140.0	65.0	77.0	31.6	169.3	81.6	87.7	76.2	16.0	529.6	54000	52.2
HR45054-R	450												37.5
HR60054-R	600												32.9

Standard conveyor chain (F roller type)

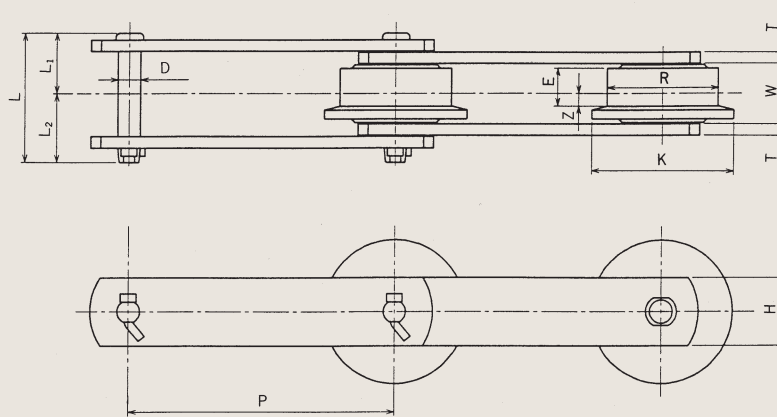

Chain No.	pitch P (mm)	Roller				Inner width W (mm)	Pin			Link plate		Average ultimate strength		Mass (kg/m)	
		Outer Dia. R (mm)	face width E (mm)	Flange diameter K (mm)	Offset Z (mm)		Dia. D (mm)	Length			Height H (mm)	Thickness T (mm)	(kN)		(kgf)
								L (mm)	L1 (mm)	L2 (mm)					
HRS03075-F	75	30.0	10.6	38	3.6	16.0	7.9	38.0	16.8	21.2	22.2	3.2	29.4	3000	2.4
HRS03100-F	100														2.1
HRS03150-F	150														1.8
HRS05100-F	100	40.0	14.5	50	4.8	22.0	11.0	53.4	23.9	29.5	31.8	4.7	68.6	7000	5.0
HRS05150-F	150														4.1
HR10108-F	101.6	44.5	18.0	55	6.5	27.0	11.0	65.7	30.6	35.1	28.6	6.3	78.5	8000	7.2
HR15208-F	152.4	50.8	20.0	65	7.0	30.2		68.0	31.4	36.6	38.1				8.0
HR10011-F	100	50.8	20.0	65	7.0	30.2	14.2	72.2	32.8	39.4	38.1	6.3	112.8	11500	10.0
HR15011-F	150														8.1
HR10113-F	101.6	44.5	20.0	60	7.0	31.6	15.8	81.3	37.3	44.0	38.1	7.9	132.4	13500	11.0
HR15215-F	152.4	57.2	25.0	75	9.0	37.1	15.8	87.5	40.0	47.5	44.5	7.9	186.3	19000	12.4
HR20015-F	200	65.0	24.0	85	8.0										12.4
HR25015-F	250	80.0	34.0	105	12.0	51.4	18.9	111.3	51.4	59.9	50.8	9.5	245.2	25000	10.6
HR20019-F	200														19.8
HR25019-F	250														17.3
HR30019-F	300	100.0	38.0	130	13.0	57.2	22.1	119.6	55.3	64.3	63.5	9.5	313.8	32000	15.7
HR25026-F	250														29.0
HR30026-F	300														23.6
HR45026-F	450	125.0	42.0	160	14.0	66.7	25.2	143.7	67.6	76.1	76.2	12.7	475.6	48500	18.9
HR30048-F	300														45.0
HR45048-F	450														31.9
HR60048-F	600	140.0	49.0	180	16.5	77.0	31.6	169.3	81.6	87.7	76.2	16.0	529.6	54000	27.8
HR30054-F	300														48.0
HR45054-F	450														39.3
HR60054-F	600	140.0	49.0	180	16.5	77.0	31.6	169.3	81.6	87.7	76.2	16.0	529.6	54000	34.3
HR60054-F	600														34.3

Standard Conveyor Chains

Standard conveyor chain (S roller type)

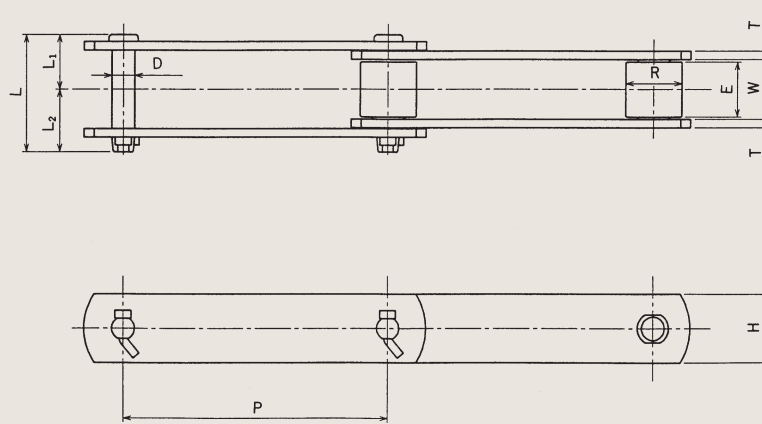

Chain No.	pitch P (mm)	Roller outer Dia. R (mm)	Inner width W (mm)	Pin			Link plate		Average ultimate strength		Mass (kg/m)											
				Dia. D (mm)	Length		Height H (mm)	Thickness T (mm)	(kN)	(kgf)												
					L (mm)	L1 (mm)						L2 (mm)										
HRS03075-S	75	15.9	16.0	7.9	38.0	16.8	21.2	22.2	3.2	29.4	3000	1.6										
HRS03100-S	100											1.4										
HRS03150-S	150											1.3										
HRS05075-S	75	22.2	22.0	11.0	53.4	23.9	29.5	31.8	4.7	68.6	7000	4.1										
HRS05100-S	100											3.5										
HRS05150-S	150											3.1										
HR10105-S	101.6	20.1	22.6	9.5	53.0	24.2	28.8	25.4	4.7	53.9	5500	3.0										
HR6608-S	66.27											22.2	27.0	11.0	65.7	30.6	35.1	28.6	6.3	78.5	8000	5.6
HR10108-S	101.6																					4.6
HR15208-S	152.4	25.4	30.2		68.0	31.4	36.6	38.1				6.0										
HR10011-S	100	29.0	30.2	14.2	72.2	32.8	39.4	38.1	6.3	112.8	11500	6.8										
HR15011-S	150											5.5										
HR7813-S	78.11	31.8	37.1	15.8	87.5	40.0	47.5	38.1	7.9	132.4	13500	10.4										
HR10113-S	101.6		31.6		81.3	37.3	44.0					8.7										
HR15215-S	152.4	34.9	37.1	15.8	87.5	40.0	47.5	44.5	7.9	186.3	19000	9.3										
HR20015-S	200											8.4										
HR25015-S	250											7.8										
HR15219-S	152.4	39.7	37.1	18.9	97.1	44.3	52.8	50.8	9.5	245.2	25000	12.6										
HR20019-S	200		12.0																			
HR25019-S	250		51.4									111.3	51.4	59.9	11.1							
HR30019-S	300		10.5																			
HR20026-S	200	44.5	57.2	22.1	119.6	55.3	64.3	63.5	9.5	313.8	32000	16.5										
HR25026-S	250											14.7										
HR30026-S	300											13.8										
HR45026-S	450											13.8										
HR30048-S	300	50.8	66.7	25.2	143.7	67.6	76.1	76.2	12.7	475.6	48500	22.9										
HR45048-S	450											20.2										
HR60048-S	600											19.0										
HR30054-S	300	57.2	77.0	31.6	169.3	81.6	87.7	76.2	16.0	529.6	54000	29.7										
HR45054-S	450											26.2										
HR60054-S	600											24.2										